

Slat mount Wall mount

Included components:

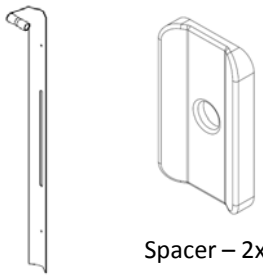

Bike rack



Spacer – 2x

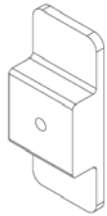

Clamp – 2x  
(slat mount only)



1/4-20 x 3/4" SBHCS  
– 2x  
(slat mount only)

Tools Required

- 5/32 hex key (slat mount only)
- (2) Screws for securing to wall (wall mount only), max 1/4" dia.
- (2) #12 x 1" length self-tapping screws, zinc-plated (for securing to Upfit post)

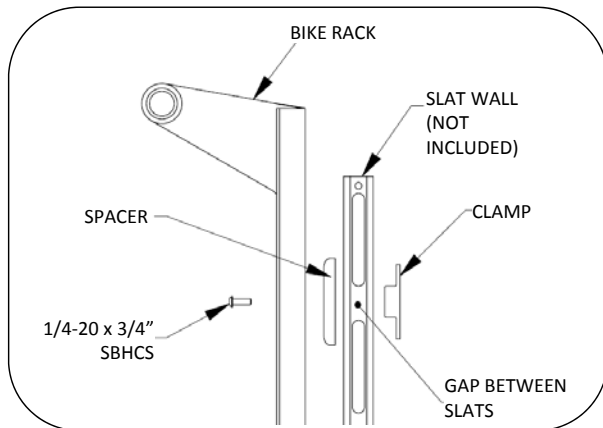

Fig. 1 – attach bike rack to Upfit slat wall

**ASSEMBLE WITH CARE!** Pangard II® Polyester Powdercoat is a strong, long-lasting finish. To protect this finish during assembly, place unwrapped powdercoated parts on packaging foam or other non-marring surface. Do not place or slide powdercoated parts on concrete or other hard or textured surface – this will damage the finish causing rust to occur. Use touch-up paint on any gouges in the finish caused by assembly tools.

**INSTALLATION:**

Attach to Upfit slat wall:

1. Install bike rack using provided spacer, clamp and screw – 2 locations per bike rack – as shown in Fig. 1. Slat wall needs to be a minimum of 72" tall.

Attach to Upfit post:

1. Place bike rack in position on post. Follow spacing guidelines in Fig. 2 for height above grade. Place spacers between bike rack and post at both hole locations.
2. Install using (2) #12 x 1" self-tapping screws (not included). Do not use stainless steel hardware to attach bike rack to Upfit post.

Attach to wall or other structure:

1. Place bike rack in position. Follow spacing guidelines in Fig. 2 for height above grade. Place spacers between bike rack and mounting surface at both hole locations.
2. Install using (2) anchors, provided by installer.

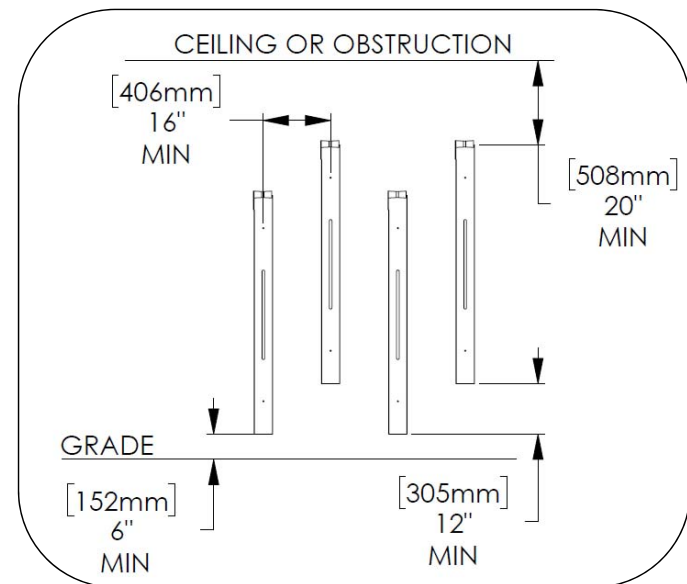

Fig. 2 – recommended spacing